

Model:
PRS Hollowbody II Piezo

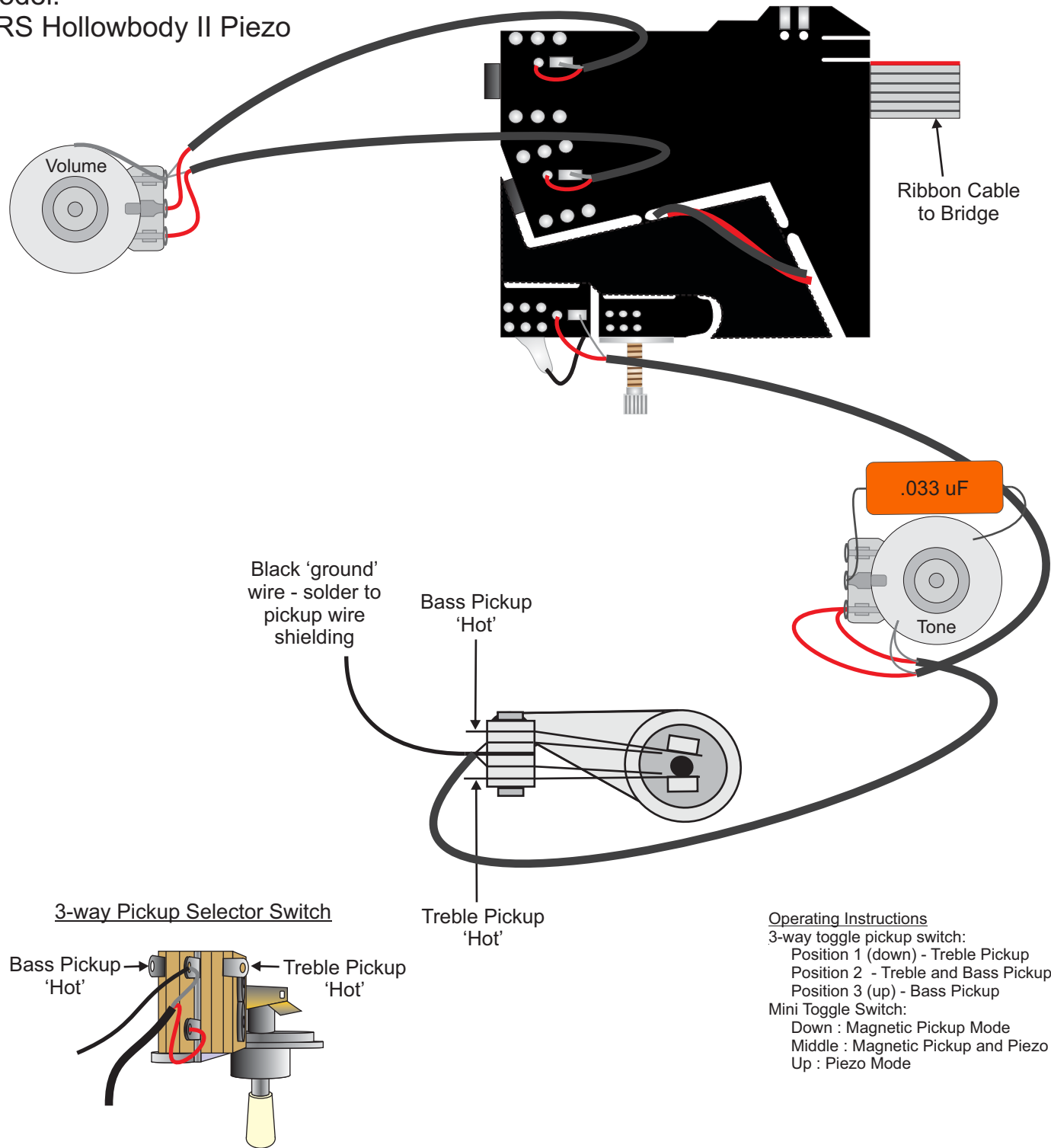

Note Pickup shape is just for reference.
All pickups using this diagram
shall be oriented in this manner.

Bass (Neck) Pickup

South

North

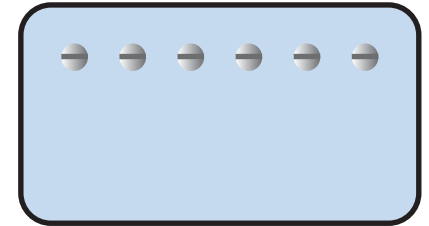

Treble (Bridge) Pickup

South

North

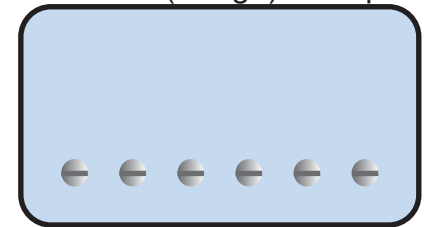

Bridge location

Operating Instructions

3-way toggle pickup switch:

- Position 1 (down) - Treble Pickup
- Position 2 - Treble and Bass Pickups
- Position 3 (up) - Bass Pickup

Mini Toggle Switch:

- Down : Magnetic Pickup Mode
- Middle : Magnetic Pickup and Piezo Modes
- Up : Piezo Mode